

PRODUCT CUT SHEET

INSTA-VALVE 20-24

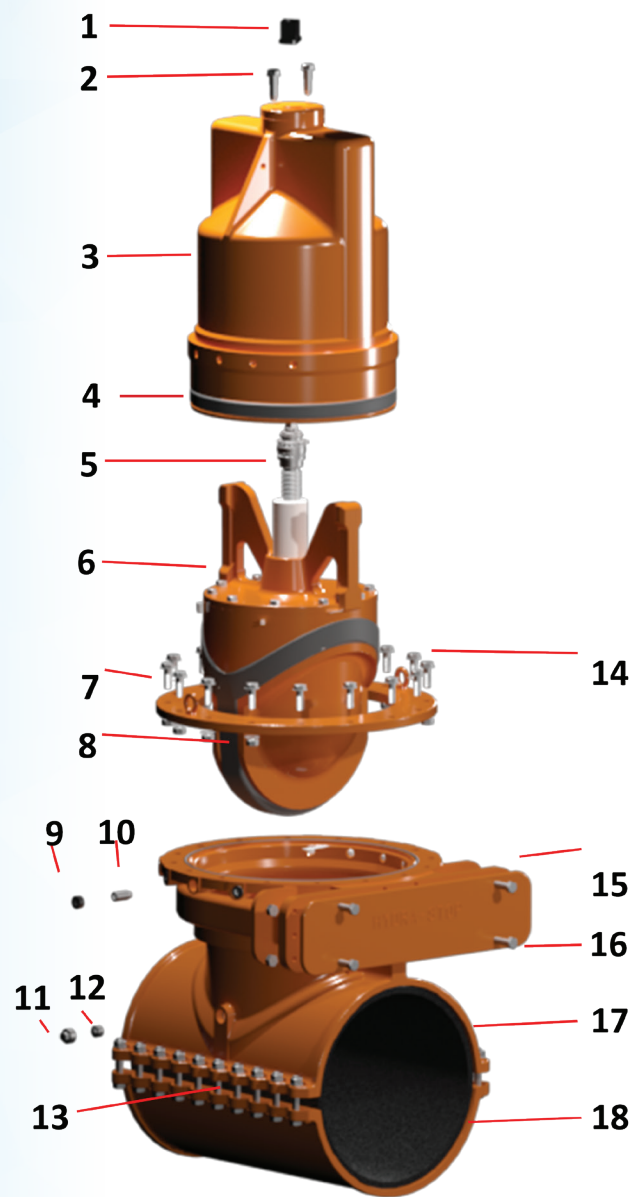

Item	Name	Material	Qty.
1	Operating Nut	Steel, Cast	1
2	Bonnet Cover Bolts	Stainless Steel	4
3	Bonnet Cover	Ductile Iron	1
4	Seal Ring	SBR Rubber	1
5	Feed Screw	Stainless Steel	1
6	Valve Cartridge Assembly	Various	1
7	Bonnet Flange	Ductile Iron	1
8	Resilient Wedge	SBR Rubber	1
9	Set Pin Cover Plug	Steel, S25C	20" valve: 6 24" valve: 8
10	Set Pin	Stainless Steel	20" valve: 6 24" valve: 8
11	Seal Plug Cover	Stainless Steel	1
12	Seal Plug	Stainless Steel	1
13	Valve Mounting Hardware (Bolts, Nuts, Washers)	Stainless Steel	20" valve: Bolts: 18 Nuts: 18 Washers: 36 24" valve: Bolts: 22 Nuts: 22 Washers: 44
14	Bonnet Flange Hardware	Stainless Steel	Bolts: 16 Nuts: 16 Washers: 32
15	Gate Valve Cover	Ductile Iron	1
16	Gate Valve Cover Bolts	Stainless Steel	4
17	Upper Valve Body	Ductile Iron	1
18	Lower Valve Body	Ductile Iron	1

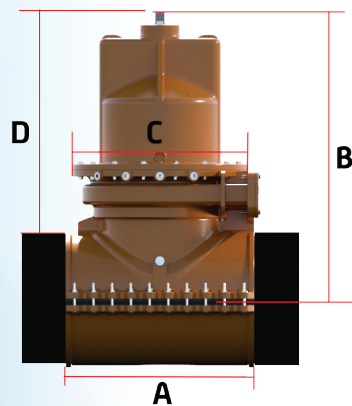

Dimensions					
Size	A	B	C	D	Approx. Weight
20"	35.5"	52.5"	32.5"	42"	2,228 lbs
24	39.5"	60.5"	36"	47"	3,139 lbs

Other Specifications
Valve Body Minimum Test Pressure: 1.5 times system working pressure
Valve Body Maximum Test Pressure: 225 psi, Maximum Working Pressure: 150 psi
Coatings: Inside: 0.3 mm epoxy powder coating. Outside: 0.25 mm epoxy powder coating.
Valve ID Range: The ID range for the 20-inch insertion valve is 20.00"-20.82" and the 24-inch insertion valve's is 24.00"-24.89".
Valve OD Range: The OD range for the 20-inch insertion valve is 21.45"-22.25" and the 24-inch insertion valve's is 25.65"-26.47".

Proprietary Information: This property of Hydra-Stop shall not be used, reproduced, or distributed without written consent. All design and invention rights are reserved. Materials, pricing, and specifications subject to change without notice.

